

LOCATION MAP

LATITUDE: 39°00'52" N LONGITUDE: 82°34'27" W

PORTION TO BE IMPROVED	=====
INTERSTATE HIGHWAY	=====
FEDERAL ROUTES	=====
STATE ROUTES	=====
COUNTY & TOWNSHIP ROADS	=====
OTHER ROADS	=====

DESIGN DESIGNATION

CURRENT ADT (2026)	17419
DESIGN YEAR ADT (2046)	17419
DESIGN HOURLY VOLUME (2046)	1742
DIRECTIONAL DISTRIBUTION	50%
TRUCKS (24 HOUR B&C)	29%
DESIGN SPEED	60 MPH
LEGAL SPEED	60 MPH
DESIGN FUNCTIONAL CLASSIFICATION:	
RURAL PRINCIPAL ARTERIAL	
NHS PROJECT	YES

DESIGN EXCEPTIONS

NONE REQUIRED

ADA DESIGN WAIVERS

NONE REQUIRED

UNDERGROUND UTILITIES
Contact Two Working Days
Before You Dig



OHIO811.org
Before You Dig

OHIO811, 8-1-1, or 1-800-362-2764
(Non members must be called directly)



**AMERICAN
STRUCTUREPOINT
INC.**

2550 CORPORATE EXCHANGE DR, STE 300
COLUMBUS, OH 43231
TEL 614.901.2235 FAX 614.901.2236
www.structurepoint.com

STATE OF OHIO
DEPARTMENT OF TRANSPORTATION

16.50
JAC-35-18.16

JACKSON COUNTY
FRANKLIN TOWNSHIP

INDEX OF SHEETS:

TITLE SHEET	1
TYPICAL SECTIONS	2-3
GENERAL NOTES	4
MAINTENANCE OF TRAFFIC	5-10
GENERAL SUMMARY	11
SUBSUMMARIES	12-14
PLAN AND PROFILE	15-16
CROSS SECTIONS	17-22
PAVEMENT DETAILS	23-24

PART 2

FOR PART 1, SEE JAC-35-18.16

STAGE 3 SUBMISSION - 11/21/25

STANDARD CONSTRUCTION DRAWINGS						SUPPLEMENTAL SPECIFICATIONS	SPECIAL PROVISIONS
BP-3.1	1/19/24	TC-41.20	10/18/13			800	7/18/25
		TC-41.30	4/21/23			832	7/18/25
DM-1.1	1/17/25	TC-42.20	10/18/13				
DM-1.2	1/17/25	TC-52.20	1/15/21				
DM-4.3	1/15/16	TC-65.10	1/17/14				
DM-4.4	1/15/16	TC-65.11	1/17/25				
		TC-71.10	7/18/25				
RM-4.2	7/18/25						
MT-99.20	4/19/19			SEE PART 1		SEE PART 1	SEE PART 1
MT-101.70	7/19/24						
MT-101.75	7/21/23						
MT-101.90	7/17/20						
MT-102.10	7/21/23						
MT-105.10	1/17/20						

FEDERAL PROJECT NUMBER

E230(562)

RAILROAD INVOLVEMENT

NONE

PROJECT DESCRIPTION

THIS PROJECT WILL CONSTRUCT A LEFT TURN LANE ON EASTBOUND US 35 AT THE AT-GRADE INTERSECTION WITH STANDPIPE ROAD. ADDITIONAL IMPROVEMENTS INCLUDE GRADING AND TRAFFIC CONTROL. TOTAL PROJECT LENGTH IS 365'.

EARTH DISTURBED AREAS

PROJECT EARTH DISTURBED AREA:	0.311 ACRES
ESTIMATED CONTRACTOR EARTH DISTURBED AREA:	0.141 ACRES
NOTICE OF INTENT EARTH DISTURBED AREA:	NOI NOT REQUIRED

LIMITED ACCESS

THIS IMPROVEMENT IS ESPECIALLY DESIGNED FOR THROUGH TRAFFIC AND HAS BEEN DECLARED A LIMITED ACCESS HIGHWAY OR FREEWAY BY ACTION OF THE DIRECTOR IN ACCORDANCE WITH THE PROVISIONS OF SECTION 5511.02 OF THE OHIO REVISED CODE.

2023 SPECIFICATIONS

THE STANDARD SPECIFICATIONS OF THE STATE OF OHIO, DEPARTMENT OF TRANSPORTATION, INCLUDING SUPPLEMENTAL SPECIFICATIONS LISTED IN THE PLANS AND CHANGES LISTED IN THE PROPOSAL SHALL GOVERN THIS IMPROVEMENT.

I HEREBY APPROVE THESE PLANS AND DECLARE THAT THE MAKING OF THIS IMPROVEMENT WILL NOT REQUIRE THE CLOSING TO TRAFFIC OF THE HIGHWAY AND THAT PROVISIONS FOR THE MAINTENANCE AND SAFETY OF TRAFFIC WILL BE AS SET FORTH ON THE PLANS AND ESTIMATES.

Michael G. Dombrowski
District 09 Deputy Director

Pamela Boratyn
Director, Department of Transportation

LEGEND

- 1

ITEM 442 - 2" ASPHALT CONCRETE SURFACE COURSE, 12.5 MM, TYPE A (448)
- 2

ITEM 407 - NON-TRACKING TACK COAT (0.055 GAL/SY)
- 3

ITEM 442 - 3" ASPHALT CONCRETE INTERMEDIATE COURSE, 19 MM, TYPE A (448)
- 4

ITEM 302 - 4" ASPHALT CONCRETE BASE, PG64-22, (449)
- 5

ITEM 302 - 5" ASPHALT CONCRETE BASE, PG64-22, (449)
- 6

ITEM 304 - 6" AGGREGATE BASE
- 7

ITEM 204 - SUBGRADE COMPACTION
- 8

ITEM 204 - PROOF ROLLING
- 9

ITEM 659 - SEEDING AND MULCHING
- 10

ITEM 605 - 6" BASE PIPE UNDERDRAINS

- A

EXISTING 5"± ASPHALT PAVEMENT
- B

EXISTING 9"± REINFORCED CONCRETE PAVEMENT
- C

EXISTING 6"± AGGREGATE BASE

+OR AS SHOWN ON THE CROSS SECTIONS
#SEE PAVEMENT DETAILS FOR CROSS SLOPE INFORMATION

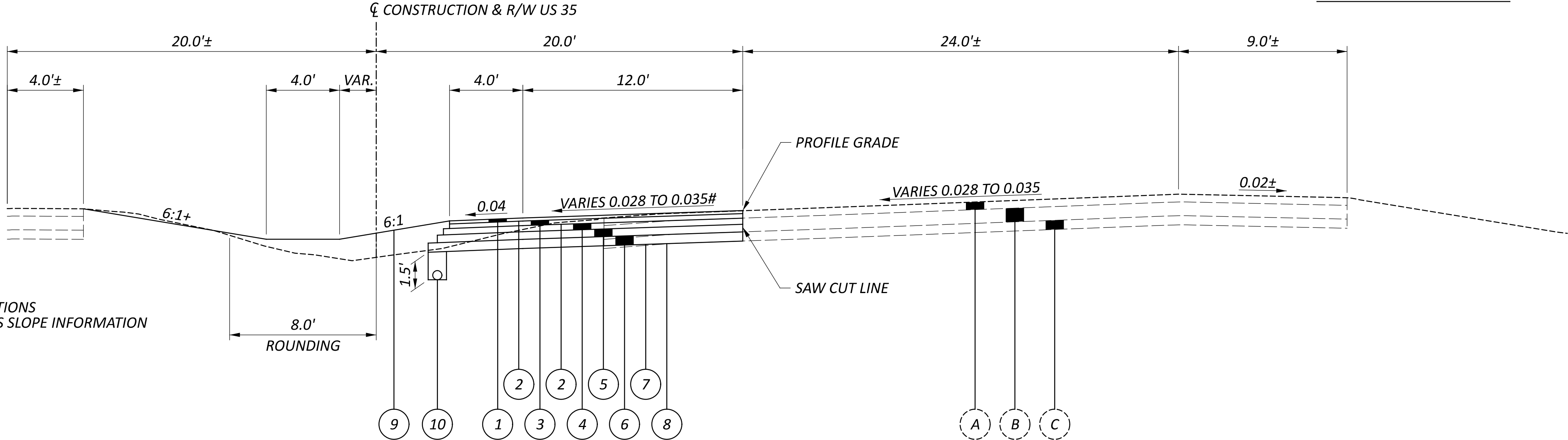

SUPERELEVATED SECTION - US 35

SECTION APPLIES:
STA. 871+75.00 TO STA. 874+89.64

+OR AS SHOWN ON THE CROSS SECTIONS
#SEE PAVEMENT DETAILS FOR CROSS SLOPE INFORMATION

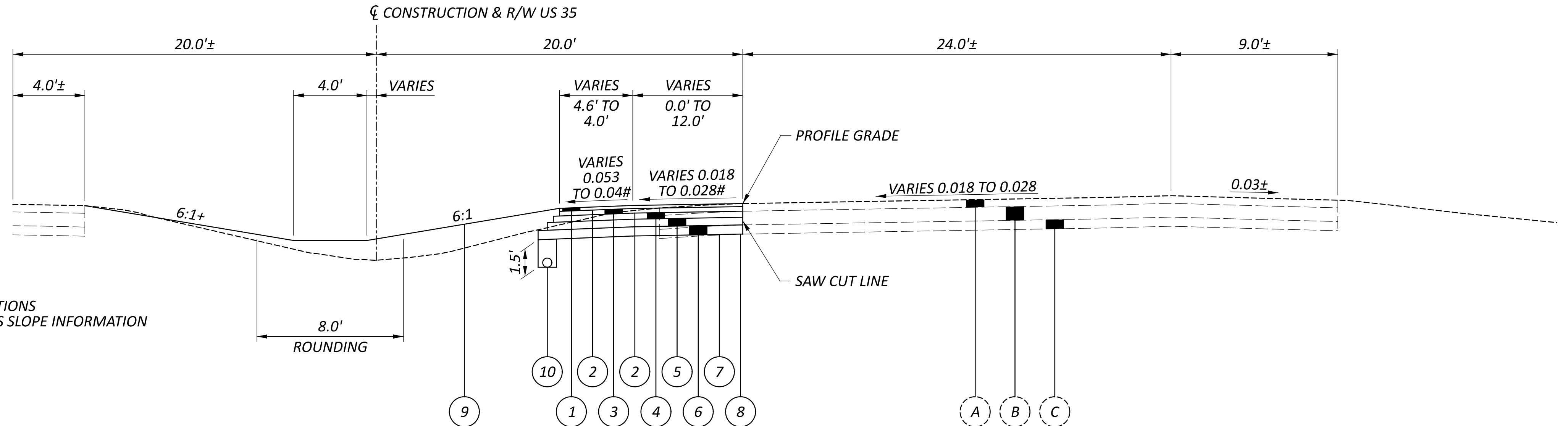

SUPERELEVATED SECTION - US 35

SECTION APPLIES:
STA. 871+25.00 TO STA. 871+75.00

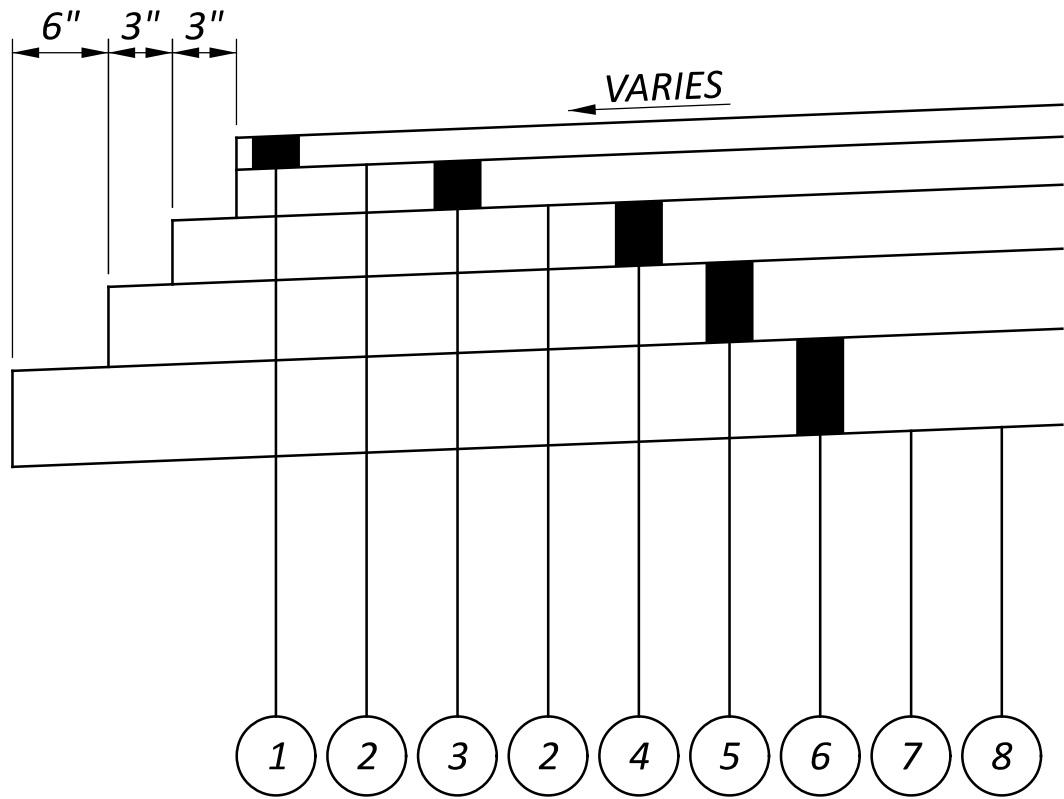

PAVEMENT STEP DETAIL

LEGEND

- A

EXISTING 5"± ASPHALT PAVEMENT
- B

EXISTING 9"± REINFORCED CONCRETE PAVEMENT
- C

EXISTING 6"± AGGREGATE BASE

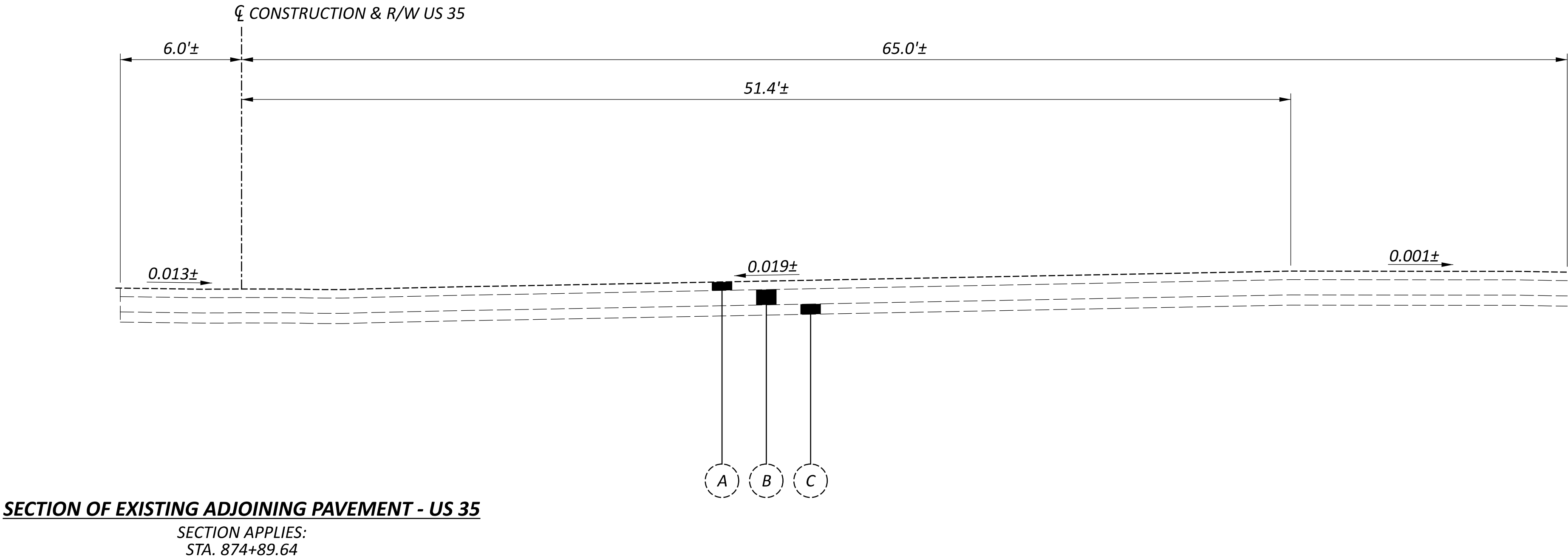
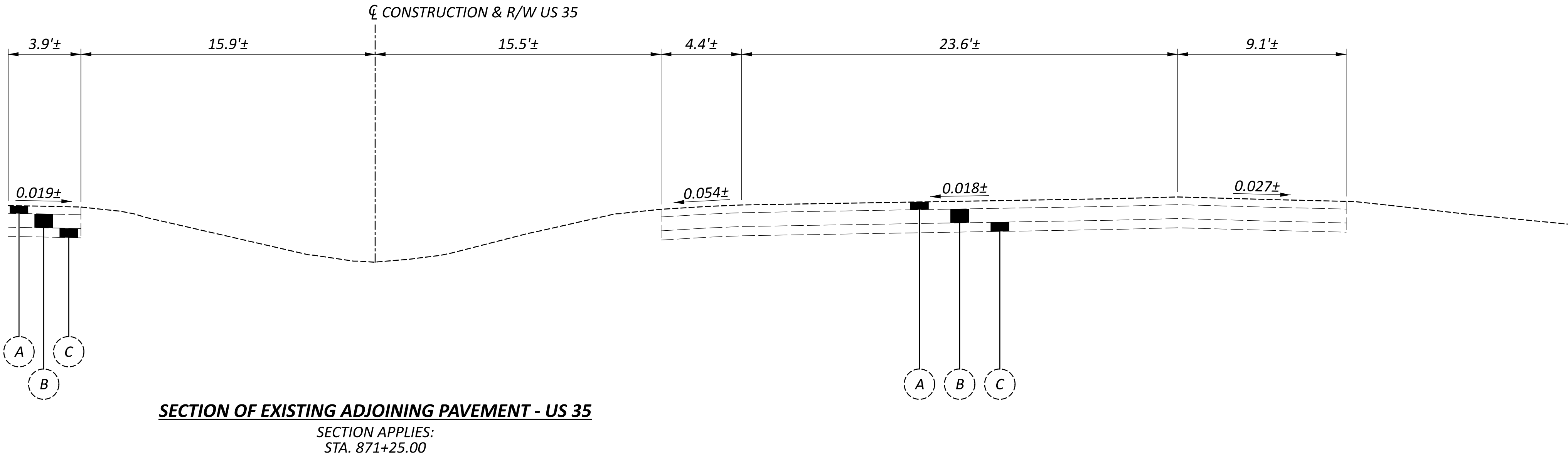

UTILITIES

LISTED BELOW ARE ALL UTILITIES LOCATED WITHIN THE PROJECT CONSTRUCTION LIMITS TOGETHER WITH THEIR RESPECTIVE OWNERS:

WATER:
JACKSON COUNTY WATER CO.
PO BOX 309
JACKSON, OH 45640
PHONE: 740-2688-1420
ATTN: ZACK STEPP

TELECOMMUNICATIONS
AT&T
160 N. 6TH STREET
ZANESVILLE, OH 43701
PHONE: 740-454-3552
ATTN: BARRETT TAMASOVICH

ELECTRIC:
BUCKEYE RURAL ELECTRIC
PO BOX 200
RIO GRANDE, OH 45674
PHONE: 740-578-9604
ATTN: JIM SOWARDS

TELECOMMUNICATIONS
TIME WARNER (CHARTER)
32 ENTERPRISE PLACE DRIVE
CHILLICOTHE, OH 45601
PHONE: 740-648-3099
ATTN: JOSEPH BAILEY

THE LOCATION OF THE UNDERGROUND UTILITIES SHOWN ON THE PLANS ARE AS OBTAINED FROM THE OWNERS AS REQUIRED BY SECTION 153.64 O.R.C.

CLEARING AND GRUBBING

ALTHOUGH THERE ARE NO TREES OR STUMPS SPECIFICALLY MARKED FOR REMOVAL WITHIN THE LIMITS OF THE PROJECT, A LUMP SUM QUANTITY IS INCLUDED IN THE GENERAL SUMMARY FOR ITEM 201, CLEARING AND GRUBBING. ALL PROVISIONS AS SET FORTH IN THE SPECIFICATIONS UNDER THIS ITEM ARE INCLUDED IN THE LUMP SUM PRICE BID FOR ITEM 201, CLEARING AND GRUBBING.

ITEM 204 - PROOF ROLLING

THE FOLLOWING QUANTITY IS PROVIDED IN THE GENERAL SUMMARY TO ADDRESS LOCATIONS REQUIRING PROOF ROLLING.

ITEM 204 - PROOF ROLLING1 HOUR

SEEDING AND MULCHING

THE FOLLOWING QUANTITIES ARE PROVIDED TO PROMOTE GROWTH AND CARE OF PERMANENT SEEDED AREAS:

659, SOIL ANALYSIS TEST
659, TOPSOIL
(788 X 111/1000) = 87.47 CY
659, SEEDING AND MULCHING
659, REPAIR SEEDING AND MULCHING
(788 X 0.05) = 39.40 SY
659, INTER-SEEDING
(788 X 0.05) = 39.40 SY
659, COMMERCIAL FERTILIZER
(788 / 7410 + 40/11115) = 0.11 TON
659, LIME
(788 / 4840) = 0.16 ACRES
659, WATER
(788 X 0.0054 + 40 X 0.0027) = 4.36 MGAL

2 EACH
88 CY

788 SY (CAD GENERATED)
40 SY
40 SY

0.11 TON

0.16 ACRES
5 MGAL

SEEDING AND MULCHING SHALL BE APPLIED TO ALL AREAS OF EXPOSED SOIL BETWEEN THE RIGHT-OF-WAY LINES, AND WITHIN THE CONSTRUCTION LIMITS FOR AREAS OUTSIDE THE RIGHT-OF-WAY LINES COVERED BY WORK AGREEMENT OR SLOPE EASEMENT. QUANTITY CALCULATIONS FOR SEEDING AND MULCHING ARE BASED ON THESE LIMITS.

EXISTING SUBSURFACE DRAINAGE

PROVIDE UNOBSTRUCTED OUTLETS FOR ALL EXISTING UNDERDRAINS OR AGGREGATE DRAINS ENCOUNTERED DURING CONSTRUCTION.

PROVIDE AN OUTLET PER STANDARD CONSTRUCTION DRAWING DM-1.1 FOR ALL UNDERDRAINS THAT OUTLET TO A SLOPE. UNDERDRAINS THAT CAN BE CONNECTED TO THE NEW OR EXISTING UNDERDRAINS AT THE END OF THE PROJECT LIMITS AS WELL AS ALL NECESSARY BENDS OR BRANCHES REQUIRED FOR CONNECTION ARE INCLUDED IN THE BASIS OF PAYMENT FOR UNCLASSIFIED PIPE UNDERDRAINS.

THE FOLLOWING ESTIMATED QUANTITIES HAVE BEEN INCLUDED IN THE GENERAL SUMMARY FOR THE WORK NOTED ABOVE:

ITEM 601, TIED CONCRETE BLOCK MAT, TYPE 1
ITEM 611, 6" CONDUIT, TYPE F
ITEM 611, PRECAST REINFORCED CONCRETE OUTLET
ITEM 605, 6" UNCLASSIFIED PIPE UNDERDRAINS

2 SY
50 FT
1 EACH
50 FT

SURVEYING PARAMETERS - OHIO STATE PLANE (NORTH/SOUTH)

PRIMARY PROJECT CONTROL MONUMENTS GOVERN ALL POSITIONING ON ODOT PROJECTS. SEE THIS SHEET OF THE PLANS FOR A TABLE CONTAINING PROJECT CONTROL INFORMATION.

USE THE FOLLOWING PROJECT CONTROL, VERTICAL POSITIONING, AND HORIZONTAL POSITIONING PARAMETERS FOR ALL SURVEYING:

PROJECT CONTROL
POSITIONING METHOD: GNSS/VRS
MONUMENT TYPE: TYPE B

VERTICAL POSITIONING
ORTHOMETRIC HEIGHT DATUM: NAVD 88
GEOID: GRS80

HORIZONTAL POSITIONING
REFERENCE FRAME: NAD83 (2011)
ELLIPSOID: GRS80
COORDINATE SYSTEM: OCCS JACKSON
MAP PROJECTION: LCC 1 PARALLEL
PROJECT ADJUSTMENT FACTOR: 1.000027
CENTRAL LATITUDE: N 39°03'00"
CENTRAL LONGITUDE: E 277°24'00"
FALSE NORTHING: 328083.33
FALSE EASTING: 164041.67

USE THE POSITIONING METHODS AND MONUMENT TYPE USED IN THE ORIGINAL SURVEY TO RESTORE ALL MONUMENTS RELATED TO PRIMARY PROJECT CONTROL THAT ARE DAMAGED OR DESTROYED BY CONSTRUCTION ACTIVITIES. RESTORE THE DAMAGED OR DESTROYED MONUMENTS IN ACCORDANCE WITH CMS 623.

UNITS ARE IN U.S. SURVEY FEET.

ROUNDING

THE ROUNDING AT SLOPE BREAKPOINTS SHOWN ON THE TYPICAL SECTIONS APPLIES TO ALL CROSS-SECTIONS, EVEN THOUGH OTHERWISE SHOWN.

WORK LIMITS

THE WORK LIMITS SHOWN ON THESE PLANS ARE FOR PHYSICAL CONSTRUCTION ONLY. PROVIDE THE INSTALLATION AND OPERATION OF ALL WORK ZONE TRAFFIC CONTROL AND WORK ZONE TRAFFIC CONTROL DEVICES REQUIRED BY THESE PLANS WHETHER INSIDE OR OUTSIDE THESE WORK LIMITS.

CENTERLINE AND BENCHMARK INFORMATION - US 35						
STATION	OFFSET	SIDE	NORTHING	EASTING	ELEVATION	POINT
869+62.09	0.00	ON C	315499.07	171157.96		POT
871+53.01	0.00	ON C	315330.46	171247.51		PC
872+82.48	172.87	RT	315132.30	171158.72	791.34	BM 1
876+63.87	205.27	LT	315002.59	171678.91	780.84	BM 2
877+05.12	26.54	RT	314842.84	171506.48		PI
882+53.84	0.00	ON C	314413.65	171853.79		PT

ITEM 614, MAINTAINING TRAFFIC

A MINIMUM OF 2 LANES OF TRAFFIC SHALL BE MAINTAINED ON EASTBOUND US 35 AT ALL TIMES BY USE OF THE EXISTING PAVEMENT AND SHOULDERS.

LENGTH AND DURATION OF LANE CLOSURES AND RESTRICTIONS SHALL BE AT THE APPROVAL OF THE ENGINEER. IT IS THE INTENT TO MINIMIZE THE IMPACT TO THE TRAVELING PUBLIC. LANE CLOSURES OR RESTRICTIONS OVER SEGMENTS OF THE PROJECT IN WHICH NO WORK IS ANTICIPATED WITHIN A REASONABLE TIME FRAME, AS DETERMINED BY THE ENGINEER, SHALL NOT BE PERMITTED. THE LEVEL OF UTILIZATION OF MAINTENANCE OF TRAFFIC DEVICES SHALL BE COMMENSURATE WITH THE WORK IN PROGRESS.

ALL WORK AND TRAFFIC CONTROL DEVICES SHALL BE IN ACCORDANCE WITH C&MS 614 AND OTHER APPLICABLE PORTIONS OF THE SPECIFICATIONS, AS WELL AS THE OHIO MANUAL OF UNIFORM TRAFFIC CONTROL DEVICES. PAYMENT FOR ALL LABOR, EQUIPMENT AND MATERIALS SHALL BE INCLUDED IN THE LUMP SUM CONTRACT PRICE FOR ITEM 614, MAINTAINING TRAFFIC, UNLESS SEPARATELY ITEMIZED IN THE PLAN.

SEQUENCE OF CONSTRUCTION:

PHASE 1:
EASTBOUND TRAFFIC ON US 35 SHALL BE SHIFTED APPROXIMATELY 4.5' SOUTH AS SHOWN ON SHEETS P.7 THROUGH P.10 THROUGH THE USE OF PAVEMENT MARKINGS, DRUMS AND PORTABLE BARRIER. THE EXISTING PAVEMENT SHALL BE SAW CUT 20' RIGHT OF THE CENTERLINE AND THE EXISTING PAVED SHOULDER REMOVED. THE EASTBOUND LEFT TURN LANE SHALL BE CONSTRUCTED IN ITS ENTIRETY, AND THE MEDIAN GRADING COMPLETED AS SHOWN ON THE CROSS SECTIONS.

PHASE 2:
THE TEMPORARY PAVEMENT MARKINGS SHALL BE REMOVED VIA WATER BLAST METHOD, AND THE PERMANANT PAVEMENT MARKINGS AND RAISED PAVEMENT MARKERS REPLACED AT THEIR EXISTING LOCATIONS USING FLAGGERS AND/OR LAW ENFORCEMENT OFFICERS. THE DRUMS, PORTABLE BARRIER, AND TEMPORARY TRAFFIC CONTROL SHALL BE REMOVED, AND ALL SITE CLEANUP AND SEEDING AND MULCHING COMPLETED.

DUST CONTROL

THE CONTRACTOR SHALL FURNISH AND APPLY WATER FOR DUST CONTROL AS DIRECTED BY THE ENGINEER. THE FOLLOWING ESTIMATED QUANTITIES QUANTITIES HAVE BEEN INCLUDED FOR DUST CONTROL PURPOSES:

ITEM 616, WATER 1 MGAL

DRUM REQUIREMENTS

IN ADDITION TO THE REQUIREMENTS OF THE PLANS, SPECIFICATION AND PROPOSAL, DRUMS FURNISHED BY THE CONTRACTOR SHALL BE NEW AND UNUSED AT THE TIME OF ARRIVAL ON THE PROJECT. ANY DRUMS BROUGHT ON THE PROJECT, WHICH HAVE PREVIOUSLY BEEN USED ELSEWHERE, WILL NOT BE ACCEPTED.

PAYMENT FOR DRUMS SHALL BE INCLUDED IN THE LUMP SUM PRICE BID FOR MAINTAINING TRAFFIC UNLESS SEPARATELY ITEMIZED.

TRENCH FOR WIDENING

TRENCH EXCAVATION FOR BASE WIDENING SHALL BE ONLY ON ONE SIDE OF THE PAVEMENT AT A TIME. THE OPEN TRENCH SHALL BE ADEQUATELY MAINTAINED AND PROTECTED WITH DRUMS OR BARRICADES AT ALL TIMES. PLACEMENT OF PROPOSED SUBBASE AND BASE MATERIAL SHALL FOLLOW AS CLOSELY AS POSSIBLE BEHIND EXCAVATION OPERATIONS. THE LENGTH OF WIDENING TRENCH WHICH IS OPEN AT ANY ONE TIME SHALL BE HELD TO A MINIMUM AND SHALL AT ALL TIMES BE SUBJECT TO APPROVAL OF THE ENGINEER.

NOTIFICATION OF TRAFFIC RESTRICTIONS

THROUGHOUT THE DURATION OF THE PROJECT, THE CONTRACTOR SHALL NOTIFY THE PROJECT ENGINEER IN WRITING OF ALL TRAFFIC RESTRICTIONS AND UPCOMING MAINTENANCE OF TRAFFIC CHANGES. THE CONTRACTOR SHALL ENSURE THE WRITTEN NOTIFICATION IS SUBMITTED IN A TIMELY MANNER TO ALLOW THE PROJECT ENGINEER TO MEET THE REQUIRED TIME FRAMES SET FORTH IN THE TABLE BELOW TO INFORM THE SPECIAL HAULING PERMITS SECTION (HAULING.PERMITS@DOT.OHIO.GOV) AND THE DISTRICT PUBLIC INFORMATION OFFICE (PIO). THIS NOTIFICATION SHALL BE RECEIVED BY THE PROJECT ENGINEER PRIOR TO THE PHYSICAL SETUP OF ANY APPLICABLE SIGNS OR MESSAGE BOARDS.

INFORMATION SHOULD INCLUDE, BUT IS NOT LIMITED TO, ALL CONSTRUCTION ACTIVITIES THAT IMPACT OR INTERFERE WITH TRAFFIC AND SHALL LIST THE SPECIFIC LOCATION, TYPE OF WORK, ROAD STATUS, DATE AND TIME OF RESTRICTION, DURATION OF RESTRICTION, NUMBER OF LANES MAINTAINED, NUMBER OF LANES CLOSED, MINIMUM VERTICAL CLEARANCE, MINIMUM WIDTH OF DRIVABLE PAVEMENT, DETOUR ROUTES, IF APPLICABLE, AND ANY OTHER INFORMATION REQUESTED BY THE PROJECT ENGINEER.

NOTICE OF TRAFFIC RESTRICTIONS TIME TABLE		
ITEM	DURATION OF CLOSURE	NOTICE DUE TO PERMITS & PIO
RAMP & ROAD CLOSURES	>= 2 WEEKS	21 CALENDAR DAYS PRIOR TO CLOSURE
	> 12 HOURS & < 2 WEEKS	14 CALENDAR DAYS PRIOR TO CLOSURE
	<= 12 HOURS	4 BUSINESS DAYS PRIOR TO CLOSURE
LANE CLOSURES & RESTRICTIONS	>= 2 WEEKS	14 CALENDAR DAYS PRIOR TO CLOSURE
	< 2 WEEKS	5 BUSINESS DAYS PRIOR TO CLOSURE
START OF CONSTRUCTION & TRAFFIC PATTERN CHANGES	N/A	14 CALENDAR DAYS PRIOR TO IMPLEMENTATION

ANY UNFORESEEN CONDITIONS NOT SPECIFIED IN THE PLANS REQUIRING TRAFFIC RESTRICTIONS SHALL ALSO BE REPORTED TO THE PROJECT ENGINEER USING THE NOTIFICATION TIME TABLE.

DELINEATION OF PORTABLE AND PERMANENT BARRIER

BARRIER REFLECTORS AND OBJECT MARKERS SHALL BE INSTALLED ON ALL PORTABLE BARRIER (PB) USED FOR TRAFFIC CONTROL; AND, ON PERMANENT CONCRETE BARRIER (INCLUDING BRIDGE PARAPETS) LOCATED WITHIN 5 FEET OF THE EDGE OF THE ADJACENT TRAVEL LANE.

BARRIER REFLECTORS SHALL CONFORM TO C&MS 626, EXCEPT THAT THE SPACING SHALL BE AS PER TRAFFIC SCD MT-101.70. OBJECT MARKERS AND THEIR INSTALLATION SHALL CONFORM TO C&MS 614.03 AND SCD MT-101.70. WHEN THE PB OR PERMANENT BARRIER (INCLUDING BRIDGE PARAPETS) CONTAINS GLARE SCREEN, ONE SET OF THREE VERTICAL STRIPES OF SHEETING SHALL BE CONSIDERED EQUIVALENT TO AN OBJECT MARKER, ONE-WAY.

PAYMENT SHALL BE FULL COMPENSATION FOR ALL MATERIAL, LABOR, INCIDENTALS AND EQUIPMENT NECESSARY FOR FURNISHING, INSTALLING, MAINTAINING AND REMOVING EACH OF THE ABOVE ITEMS.

ITEM 614, WORK ZONE IMPACT ATTENUATOR FOR 24" WIDE HAZARDS (UNIDIRECTIONAL)

THIS ITEM SHALL CONSIST OF FURNISHING AND INSTALLING A NON-GATING IMPACT ATTENUATOR. FURNISH AN IMPACT ATTENUATOR FROM THE OFFICE OF ROADWAY ENGINEERING'S APPROVED LIST FOR WORK ZONE IMPACT ATTENUATORS, FROM THE ROADWAY STANDARDS APPROVED PRODUCTS WEB PAGE.

INSTALLATION SHALL BE AT THE LOCATIONS SPECIFIED IN THE PLANS IN ACCORDANCE WITH THE MANUFACTURER'S SPECIFICATIONS.

THE CONTRACTOR SHALL REPAIR OR REPLACE A DAMAGED UNIT WITHIN 24 HOURS OF A DAMAGING IMPACT.

WHEN BIDIRECTIONAL DESIGNS ARE SPECIFIED, THE CONTRACTOR SHALL SUPPLY APPROPRIATE TRANSITIONS.

WHEN GATING IMPACT ATTENUATORS ARE DESIRED, THE CONTRACTOR SHALL SUBMIT DOCUMENTATION TO THE ENGINEER FOR ACCEPTANCE.

THE COST FOR THE ADDITIONAL BARRIER REQUIRED FOR A GATING IMPACT ATTENUATOR SHALL BE INCLUDED IN THE COST OF THE GATING IMPACT ATTENUATOR.

PAYMENT FOR THE ABOVE WORK SHALL BE MADE AT THE UNIT PRICE BID AND SHALL INCLUDE ALL LABOR, TOOLS, EQUIPMENT AND MATERIALS NECESSARY TO CONSTRUCT AND MAINTAIN A COMPLETE AND FUNCTIONAL IMPACT ATTENUATOR SYSTEM, INCLUDING ALL RELATED BACKUPS, TRANSITIONS, LEVELING PADS, HARDWARE AND GRADING, NOT SEPARATELY SPECIFIED, AS REQUIRED BY THE MANUFACTURER.

ITEM 614, MAINTAINING TRAFFIC (ESTIMATED QUANTITIES)

THE FOLLOWING ESTIMATED QUANTITIES HAVE BEEN INCLUDED IN THE GENERAL SUMMARY TO REPLACE THE EXISTING PAVEMENT MARKINGS AND RAISED PAVEMENT MARKERS.

ITEM 621 - RPM (WHITE/RED)	20 EACH
ITEM 621 - RAISED PAVEMENT MARKER REMOVED	20 EACH
ITEM 644 - LANE LINE, 6"	0.30 MILE
ITEM 644 - EDGE LINE, 6" (WHITE)	0.28 MILE
ITEM 644 - DOTTED LINE, 6" (WHITE)	157 FT
ITEM 644 - DOTTED LINE, 6" (YELLOW)	151 FT
ITEM 644 - REMOVAL OF PAVEMENT MARKINGS	3360 FT

DESIGN AGENCY	
AMERICAN STRUCTUREPOINT	
DESIGNER	ANW
REVIEWER	
KAM PROJECT ID	11-18-25
118107	
SHEET	TOTAL
P.5	24

ITEM 614, LAW ENFORCEMENT OFFICER (WITH PATROL CAR) FOR ASSISTANCE DURING CONSTRUCTION OPERATIONS

USE OF LAW ENFORCEMENT OFFICERS (LEOS) BY CONTRACTORS OTHER THAN THE USES SPECIFIED BELOW SHALL NOT BE PERMITTED AT PROJECT COST NOR TIME COMPENSATION. LEOS SHOULD NOT BE USED WHERE THE OMUTCD INTENDS THAT FLAGGERS BE USED.

IN ADDITION TO THE REQUIREMENTS OF C&MS 614 AND THE OMUTCD, A UNIFORMED LEO WITH AN OFFICIAL PATROL CAR (CAR WITH TOP-MOUNTED EMERGENCY FLASHING LIGHTS AND COMPLETE MARKINGS OF THE APPROPRIATE LAW ENFORCEMENT AGENCY) SHALL BE PROVIDED FOR THE FOLLOWING TRAFFIC CONTROL TASKS:

- 1. DURING PERIODS WHERE TRAFFIC NEEDS TO BEDIRECTED CONTRARY TO A TRAFFIC CONTROL DEVICE (FLAGGER, SIGN [E.G. STOP SIGN, STREET OR HIGHWAY SIGNS, ETC], SIGNAL OR OTHER DEVICE USED TO REGULATE, WARN OR GUIDE TRAFFIC). TRAFFIC IN THIS INSTANCE INCLUDES VEHICULAR TRAFFIC ONLY.

IN ADDITION TO THE REQUIREMENT OF C&MS 614 AND THE OMUTCD, A UNIFORMED LEO WITH AN OFFICIAL PATROL CAR (CAR WITH TOP-MOUNTED EMERGENCY FLASHING LIGHTS AND COMPLETE MARKINGS OF THE APPROPRIATE LAW ENFORCEMENT AGENCY) SHOULD BE PROVIDED FOR THE FOLLOWING TRAFFIC CONTROL TASKS AS APPROVED BY THE ENGINEER:

- 1. FOR LANE CLOSURES THAT MEET ALL OF THE CRITERIA LISTED BELOW: DURING INITIAL SET-UP PERIODS, TEAR DOWN PERIODS, SUBSTANTIAL SHIFTS OF A CLOSURE POINT OR WHEN NEW LANE CLOSURE ARRANGEMENTS ARE INITIATED FOR LONG-TERM LANE CLOSURES/SHIFTS (FOR THE FIRST AND LAST DAY OF MAJOR CHANGES IN TRAFFIC CONTROL SETUP).
 - o CRITERIA
 - A. ON A MULTI-LANE DIVIDED INTERSTATE, OTHER FREEWAY OR EXPRESSWAY; AND,
 - B. AN AUTHORIZED SPEED LIMIT OF 45 MPH OR GREATER THAT IS IN EFFECT AT THE TIME OF THE OPERATION; AND,
 - C. AADT OF 50,000 (OR AADT OF 30,000 WITH 25% OR HIGHER PERCENT TRUCKS)

IN GENERAL, LEOS SHOULD BE POSITIONED IN ADVANCE OF AND ON THE SAME SIDE AS THE LANE RESTRICTION (OR AT THE POINT OF ROAD CLOSURE), AND TO MANUALLY CONTROL TRAFFIC MOVEMENTS THROUGH SIGNALIZED INTERSECTIONS AND/OR IN CONTRARY TO OTHER TRAFFIC CONTROL DEVICES IN WORK ZONES.

LEOS SHOULD NOT FORGO THEIR TRAFFIC CONTROL RESPONSIBILITIES TO APPREHEND MOTORISTS FOR ROUTINE TRAFFIC VIOLATIONS. HOWEVER, IF A MOTORIST'S ACTIONS ARE CONSIDERED TO BE RECKLESS, THEN PURSUIT OF THE MOTORIST IS APPROPRIATE.

THE LEOS WORK AT THE DIRECTION OF THE CONTRACTOR. THE CONTRACTOR IS RESPONSIBLE FOR SECURING THE SERVICES OF THE LEOS WITH THE APPROPRIATE AGENCIES AND COMMUNICATING THE INTENTIONS OF THE PLANS WITH RESPECT TO DUTIES OF THE LEOS. THE ENGINEER SHALL HAVE FINAL CONTROL OVER THE LEOS' DUTIES AND PLACEMENT, AND WILL RESOLVE ANY ISSUES THAT MAY ARISE BETWEEN THE TWO PARTIES.

ENSURE PROVIDED LEOS HAVE BEEN TRAINED APPROPRIATE TO THE JOB DECISIONS THEY ARE REQUIRED TO MAKE WHILE ON THE PROJECT, IN ACCORDANCE WITH C&MS 614.03.THE LEO SHALL REPORT IN TO THE CONTRACTOR PRIOR TO THE START OF THE SHIFT, IN ORDER TO RECEIVE INSTRUCTIONS REGARDING SPECIFIC WORK ASSIGNMENTS DURING HIS/HER SHIFT. THE LEO IS EXPECTED TO STAY AT THE PROJECT SITE FOR THE ENTIRE DURATION OF HIS/HER SHIFT. THE LEO SHALL REPORT TO THE

CONTRACTOR AT THE END OF HIS/HER SHIFT. SHOULD IT BE NECESSARY TO LEAVE THE PROJECT SITE, THE LEO SHALL NOTIFY THE ENGINEER. THE CONTRACTOR SHALL PROVIDE THE LEO WITH A TWO-WAY COMMUNICATION DEVICE THAT SHALL BE RETURNED TO THE CONTRACTOR AT THE END OF HIS/HER SHIFT.

LEOS (WITH PATROL CAR) REQUIRED BY THE TRAFFIC MAINTENANCE TASKS ABOVE SHALL BE PAID FOR ON A UNIT PRICE (HOURLY) BASIS UNDER ITEM 614, LAW ENFORCEMENT OFFICER (WITH PATROL CAR) FOR ASSISTANCE. THE FOLLOWING ESTIMATED QUANTITIES HAVE BEEN CARRIED TO THE GENERAL SUMMARY.

ITEM 614, LAW ENFORCEMENT OFFICER WITH PATROL CAR FOR ASSISTANCE 40 HOURS

THE HOURS PAID SHALL INCLUDE ANY MINIMUM SHOW-UP TIME REQUIRED BY THE LAW ENFORCEMENT AGENCY INVOLVED.ANY ADDITIONAL COSTS (ADMINISTRATIVE OR OTHERWISE) INCURRED BY THE CONTRACTOR TO OBTAIN THE SERVICES OF AN LEO ARE INCLUDED WITH THE BID UNIT PRICE FOR ITEM 614, LAW ENFORCEMENT OFFICER WITH PATROL CAR FOR ASSISTANCE.

DESIGN AGENCY	
AMERICAN STRUCTUREPOINT INC.	
DESIGNER	ANW
REVIEWER	
KAM PROJECT ID	11-18-25
	118107
SHEET	TOTAL
P.6	24

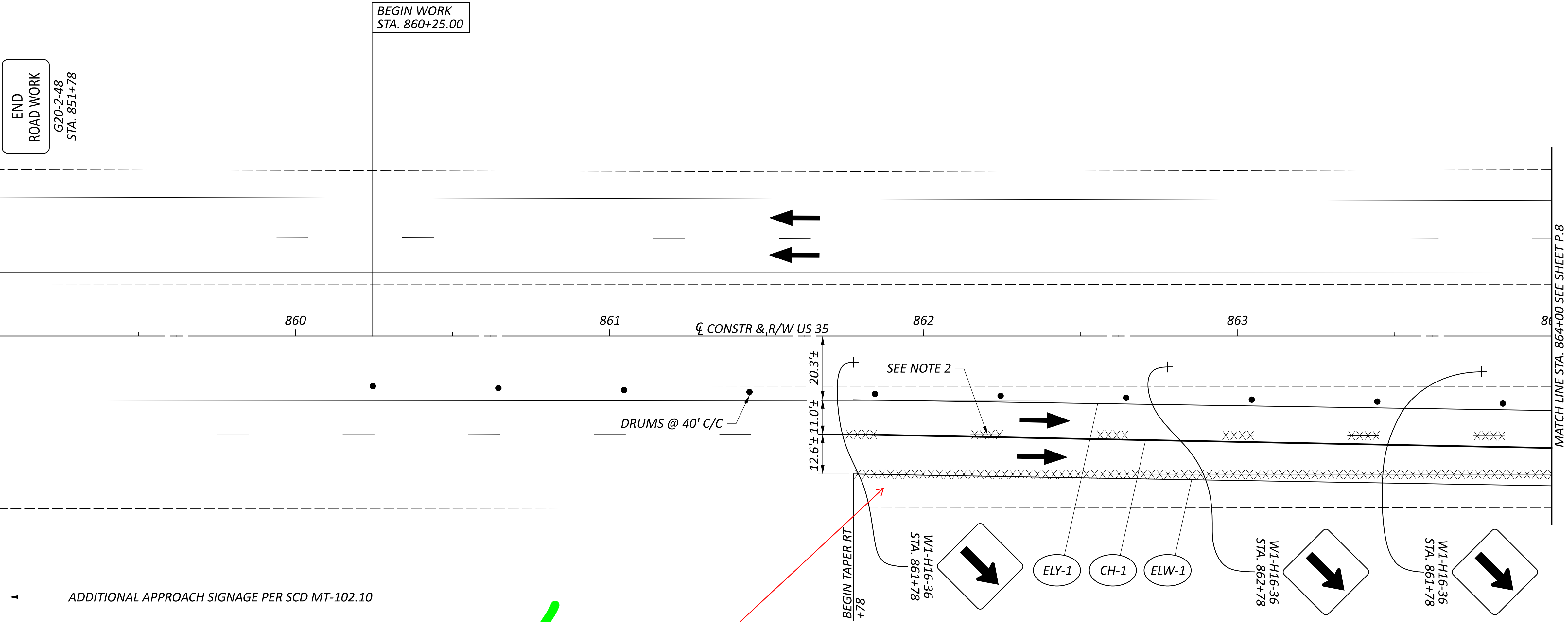

LEGEND

- ELY ITEM 614 - WORK ZONE EDGE LINE, CLASS I, 6", 642 PAINT (YELLOW)
- ELW ITEM 614 - WORK ZONE EDGE LINE, CLASS I, 6", 642 PAINT (WHITE)
- CH ITEM 614 - WORK ZONE CHANNELIZING LINE, CLASS I, 12", 642 PAINT

XXXXXX EXISTING PAVEMENT MARKINGS TO BE COVERED/REMOVED

SHOULD WE DO
SOMETHING WITH THE
EXISTING RUMBLE
STRIPS?

- NOTES
1. FOR QUANTITIES SEE SHEET P.12.
 2. COVER OR REMOVE ALL EXISTING MARKINGS VIA WATER BLAST METHOD ONLY.

MAINTENANCE OF TRAFFIC PLAN
PHASE 1

DESIGN AGENCY

AMERICAN
STRUCTUREPOINT
INC.

DESIGNER

ANW

REVIEWER

KAM 11-18-25

PROJECT ID

118107

SHEET



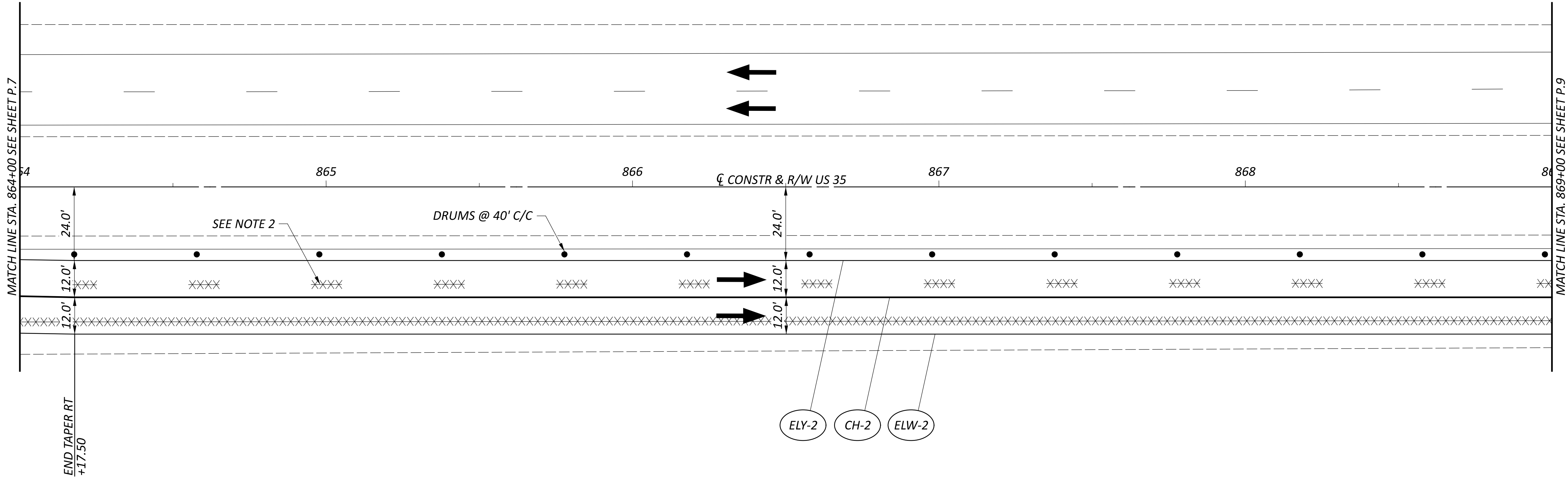

P.7

TOTAL

24

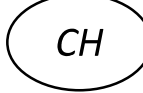

LEGEND

-  ITEM 614 - WORK ZONE EDGE LINE, CLASS I, 6", 642 PAINT (YELLOW)
-  ITEM 614 - WORK ZONE EDGE LINE, CLASS I, 6", 642 PAINT (WHITE)
-  ITEM 614 - WORK ZONE CHANNELIZING LINE, CLASS I, 12", 642 PAINT
-  EXISTING PAVEMENT MARKINGS TO BE COVERED/REMOVED

- NOTES
- FOR QUANTITIES SEE SHEET P.12.
 - COVER OR REMOVE ALL EXISTING MARKINGS VIA WATER BLAST METHOD ONLY.

MAINTENANCE OF TRAFFIC PLAN
PHASE 1

DESIGN AGENCY	
STRUCTUREPOINT	
DESIGNER	
ANW	
REVIEWER	
KAM 11-18-25	
PROJECT ID	
118107	
SHEET	TOTAL
P.8	24

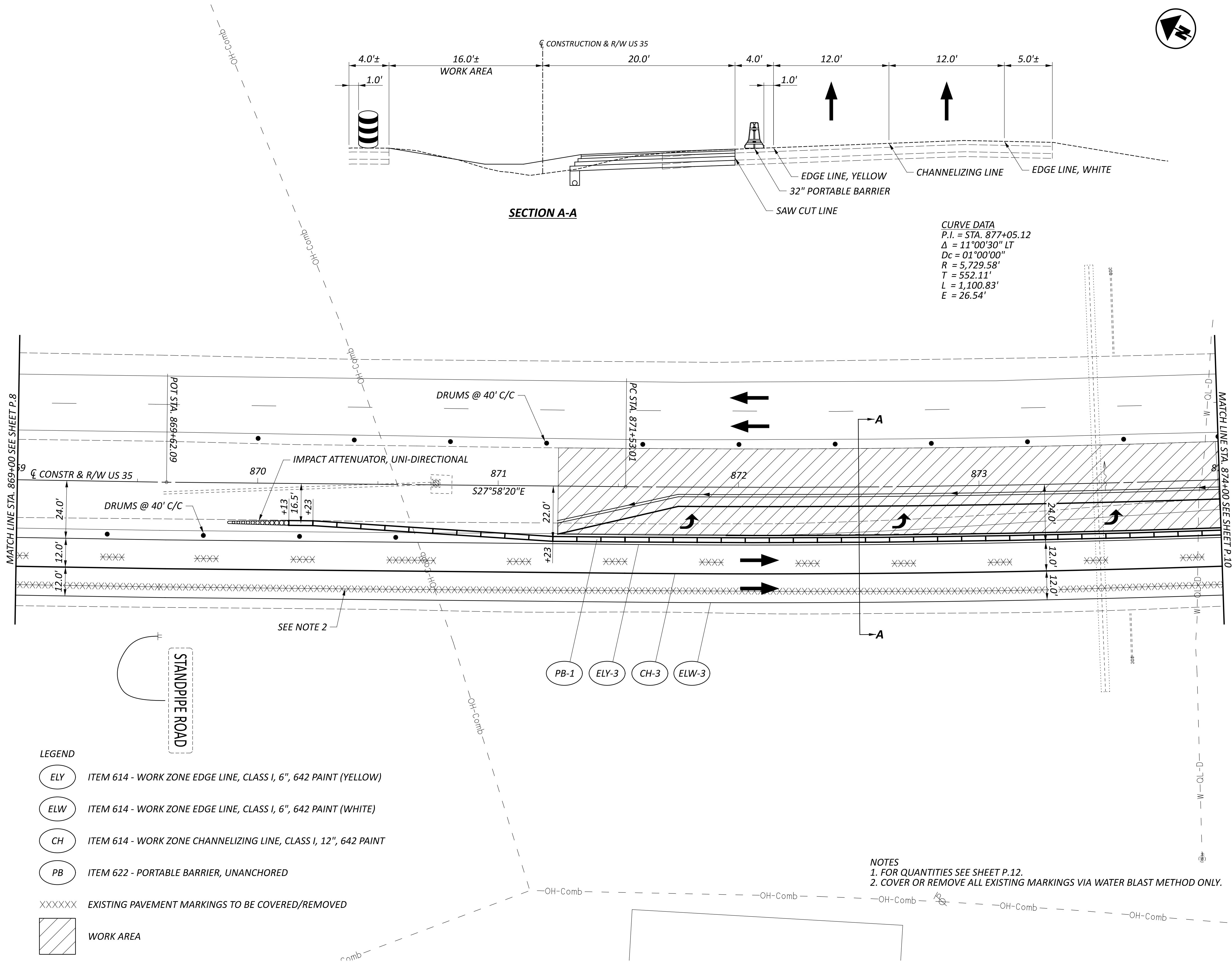

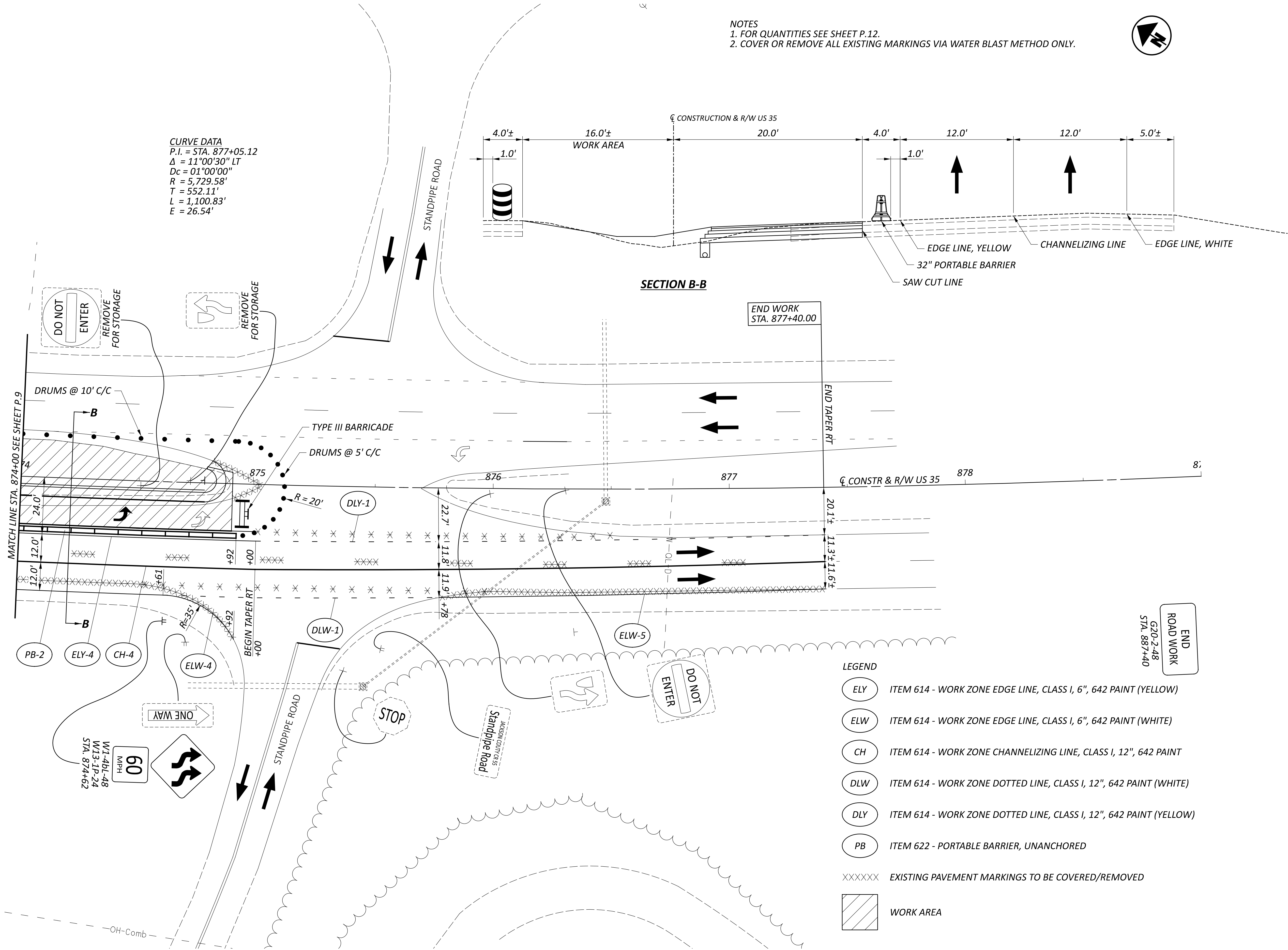

SHEET NUMBER													PART.	ITEM	ITEM EXT	GRAND TOTAL	UNIT	DESCRIPTION	SEE SHEET NO.
					P.4	P.5	P.6	P.12	P.13	P.14	P.22	OFFICE CALCS	01/NHS						
					LS								LS	201	11000	LS		ROADWAY	
									357				357	202	23000	357	SY	CLEARING AND GRUBBING	
											107		107	203	10000	107	CY	PAVEMENT REMOVED	
											127		127	203	20000	127	CY	EXCAVATION	
																		EMBANKMENT	
										686			686	204	10000	686	SY		
					1								1	204	45000	1	HOUR	SUBGRADE COMPACTION	
																		PROOF ROLLING	
																		EROSION CONTROL	
					2								2	601	21050	2	SY	TIED CONCRETE BLOCK MAT WITH TYPE 1 UNDERLAYMENT	
					2								2	659	00100	2	EACH	SOIL ANALYSIS TEST	
					88								88	659	00300	88	CY	TOPSOIL	
					788								788	659	10000	788	SY	SEEDING AND MULCHING	
					40								40	659	14000	40	SY	REPAIR SEEDING AND MULCHING	
					40								40	659	15000	40	SY	INTER-SEEDING	
					0.11								0.11	659	20000	0.11	TON	COMMERCIAL FERTILIZER	
					0.16								0.16	659	31000	0.16	ACRE	LIME	
					4.36								4.36	659	35000	4.36	MGAL	WATER	
												4,570	4,570	832	30000	4,570	EACH	EROSION CONTROL	
																		DRAINAGE	
					50								50	605	13300	50	FT	6" UNCLASSIFIED PIPE UNDERDRAINS	
									355				355	605	14000	355	FT	6" BASE PIPE UNDERDRAINS	
					50								50	611	01500	50	FT	6" CONDUIT, TYPE F	
					1								1	611	99710	1	EACH	PRECAST REINFORCED CONCRETE OUTLET	
										162			162	302	56000	162	CY	PAVEMENT	
										112			112	304	20000	112	CY	ASPHALT CONCRETE BASE, PG64-22, (449)	
										71			71	407	20000	71	GAL	AGGREGATE BASE	
										35			35	442	20000	35	CY	NON-TRACKING TACK COAT	
										53			53	442	20200	53	CY	ASPHALT CONCRETE SURFACE COURSE, 12.5 MM, TYPE A (448)	
																		ASPHALT CONCRETE INTERMEDIATE COURSE, 19 MM, TYPE A (448)	
																		TRAFFIC CONTROL	
					20								20	621	00100	20	EACH	RPM (WHITE/RED)	
					20								20	621	54000	20	EACH	RAISED PAVEMENT MARKER REMOVED	
									28				28	630	03100	28	FT	GROUND MOUNTED SUPPORT, NO. 3 POST	
									1				1	630	08600	1	EACH	SIGN POST REFLECTOR (RED)	
									2				2	630	85100	2	EACH	REMOVAL OF GROUND MOUNTED SIGN AND REERECTION	
									2				2	630	86002	2	EACH	REMOVAL OF GROUND MOUNTED POST SUPPORT AND DISPOSAL	
					0.28				0.07				0.35	644	00104	0.35	MILE	EDGE LINE, 6"	
					0.3								0.3	644	00204	0.3	MILE	LANE LINE, 6"	
									295				295	644	00404	295	FT	CHANNELIZING LINE, 12"	
									4				4	644	01300	4	EACH	LANE ARROW	
					308								308	644	01510	308	FT	DOTTED LINE, 6"	
					3,360								3,360	644	30000	3,360	FT	REMOVAL OF PAVEMENT MARKING	
							40						40	614	11110	40	HOUR	MAINTENANCE OF TRAFFIC	
									1				1	614	12380	1	EACH	LAW ENFORCEMENT OFFICER WITH PATROL CAR FOR ASSISTANCE	
									10				10	614	13310	10	EACH	WORK ZONE IMPACT ATTENUATOR, 24" WIDE HAZARDS, (UNIDIRECTIONAL)	
									10				10	614	13350	10	EACH	BARRIER REFLECTOR, TYPE 1 (UNIDIRECTIONAL)	
									0.53				0.53	614	22110	0.53	MILE	OBJECT MARKER, ONE WAY	
																		WORK ZONE EDGE LINE, CLASS I, 6", 642 PAINT	
										1,562			1,562	614	23210	1,562	FT		
									358				358	614	24202	358	FT	WORK ZONE CHANNELIZING LINE, CLASS I, 12", 642 PAINT	
					1								1	616	10000	1	MGAL	WORK ZONE DOTTED LINE, CLASS I, 6", 642 PAINT	
									460				460	622	41100	460	FT	WATER	
																		PORTABLE BARRIER, UNANCHORED	
																		INCIDENTALS	
													LS	614	11000	LS		MAINTAINING TRAFFIC	
													3	619	16000	3	MNTH	FIELD OFFICE, TYPE A	
													LS	623	10000	LS		CONSTRUCTION LAYOUT STAKES AND SURVEYING	
													LS	623	50000	LS		PRECONSTRUCTION SURVEY MONUMENT VERIFICATION AND REPORT	
													LS	623	51000	LS		POST CONSTRUCTION SURVEY MONUMENT VERIFICATION AND REPORT	
													LS	624	10000	LS		MOBILIZATION	

WILL BE INCLUDED IN PART 1

GENERAL SUMMARY

DESIGN AGENCY	
STRUCTUREPOINT	
DESIGNER	
ANW	
REVIEWER	
KAM 11-18-25	
PROJECT ID	
118107	
SHEET	TOTAL
P.11	24

MAINTENANCE OF TRAFFIC SUBSUMMARY	
DESIGN AGENCY	
AMERICAN STRUCTUREPOINT INC.	
DESIGNER	
ANW	
REVIEWER	
KAM 11-18-25	
PROJECT ID	
118107	
SHEET	TOTAL
P.12	24

PAVEMENT CALCULATIONS	
DESIGN AGENCY STRUCTUREPOINT <small>INC.</small>	
DESIGNER	ANW
REVIEWER	KAM 11-18-25
PROJECT ID	118107
SHEET	TOTAL
P.14	24

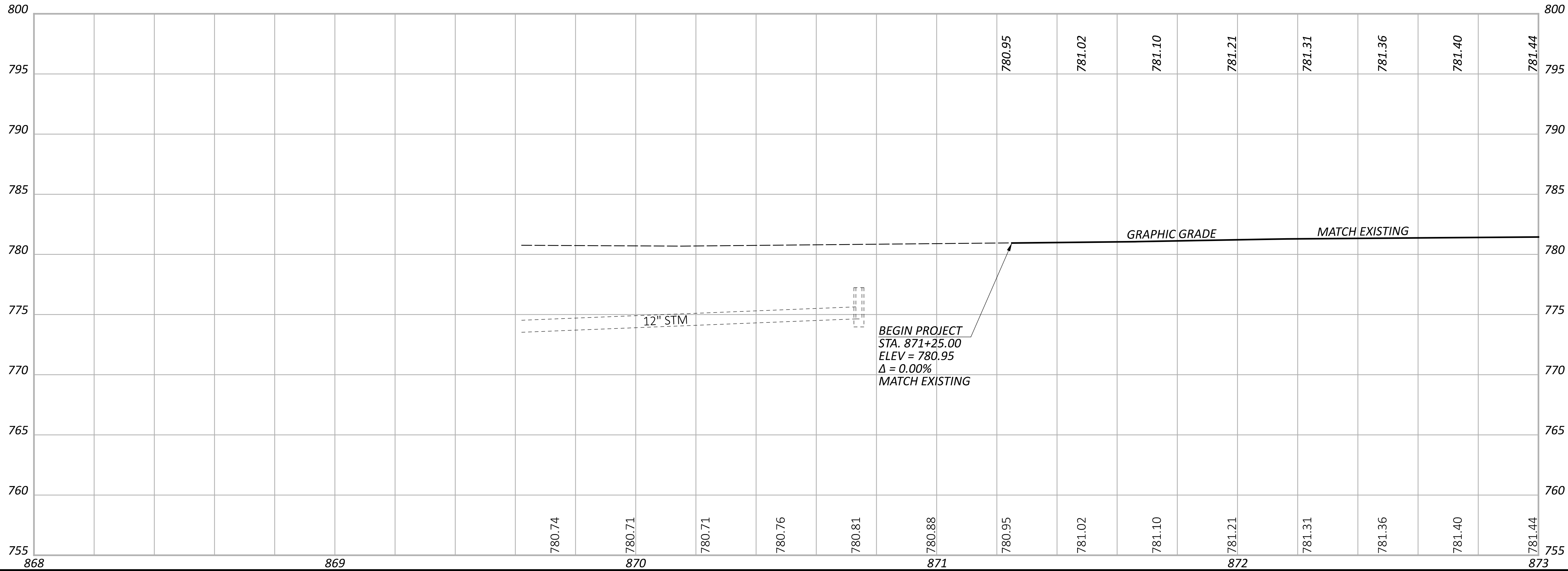

LEGEND

- ELY ITEM 644 - EDGE LINE, 6" (YELLOW)
- A ITEM 644 - LANE ARROW
- CH ITEM 644 - CHANNELIZING LINE, 12"

BEGIN WORK
STA. 860+25.00

BENCHMARK

BM #1
STA. 872+82.48, 172.87' RT
N 315132.30, E 171158.72
RR SPIKE SET IN UTILITY POLE
ELEV = 791.34

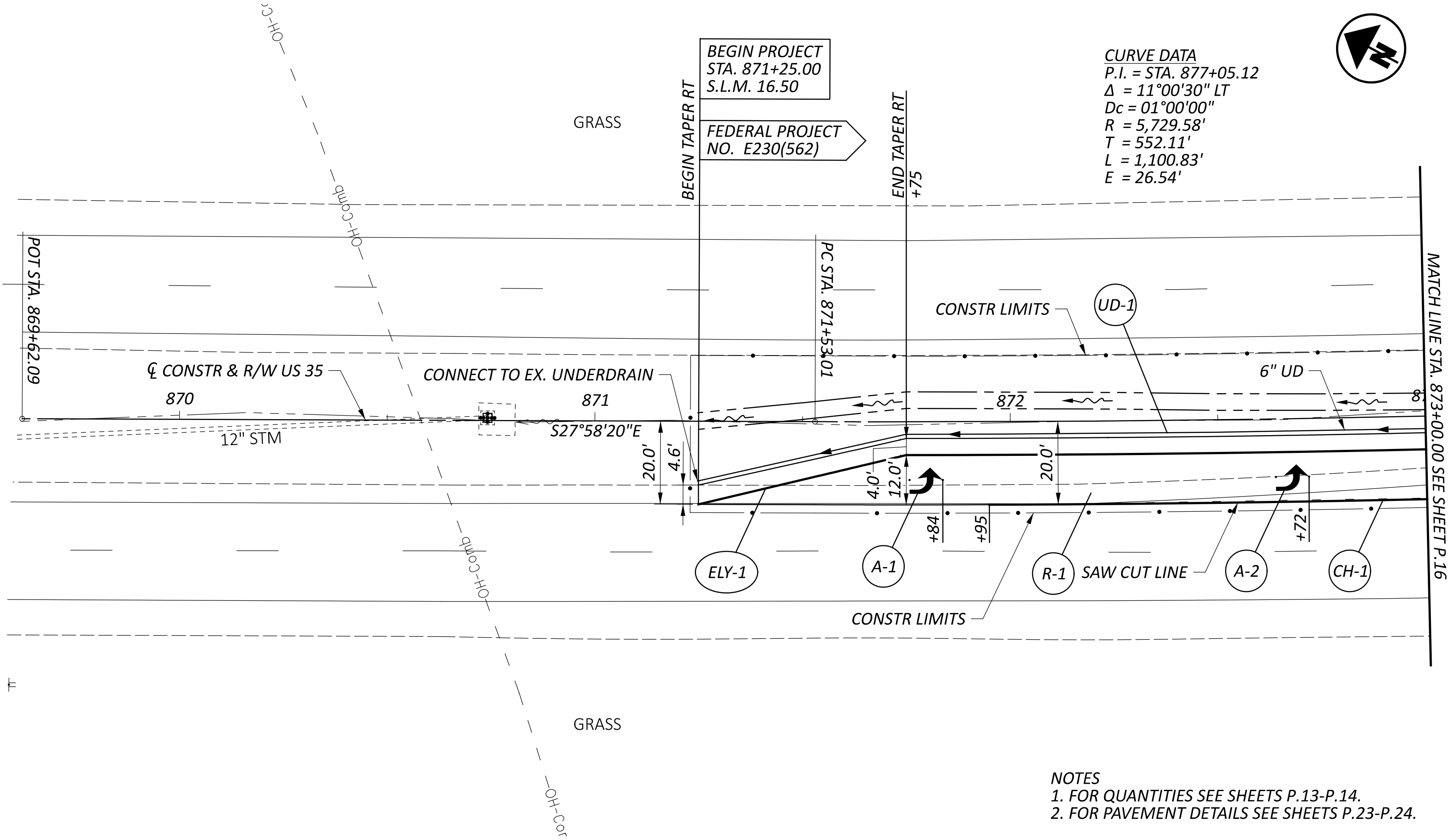

PLAN & PROFILE - US 35
STA. 873+00.00 TO STA. 878+00.00

DESIGN AGENCY

STRUCTUREPOINT

DESIGNER

ANW

REVIEWER

KAM 11-18-25

PROJECT ID

118107

SHEET

P.16

TOTAL

24

HORIZONTAL
SCALE IN FEET



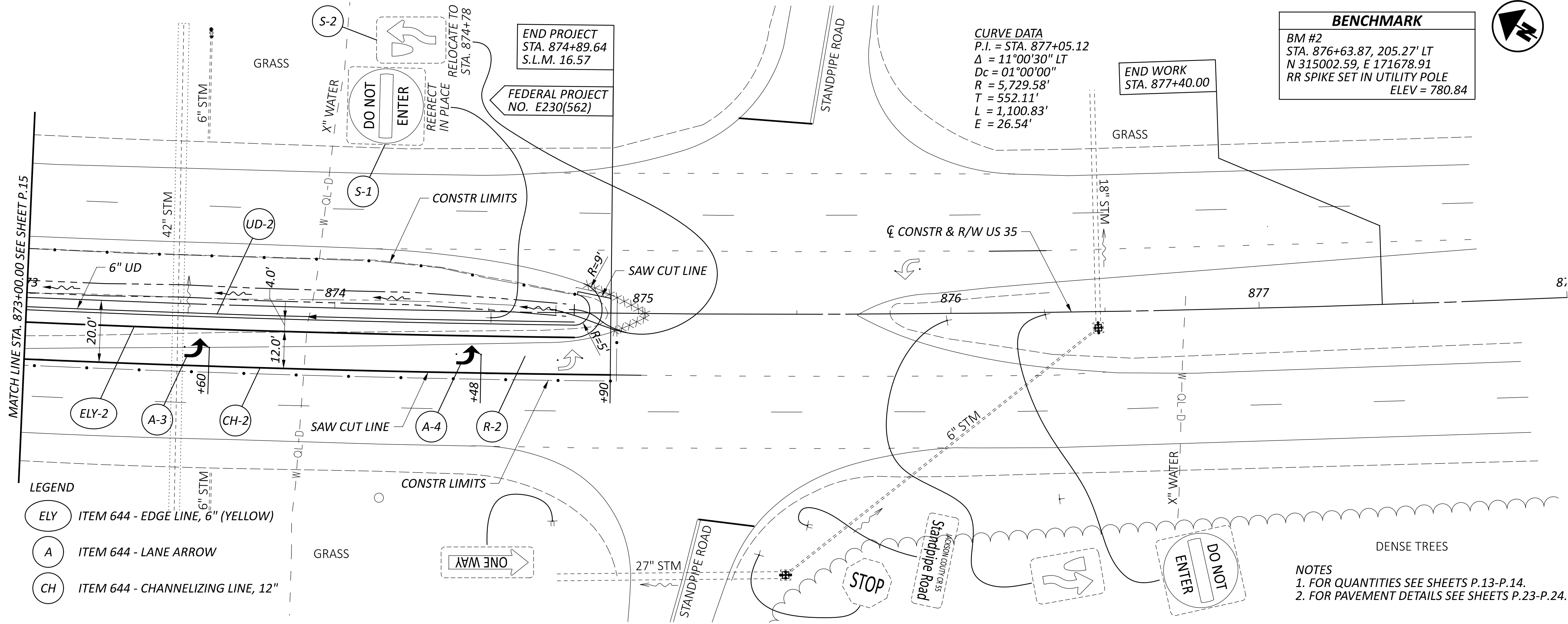
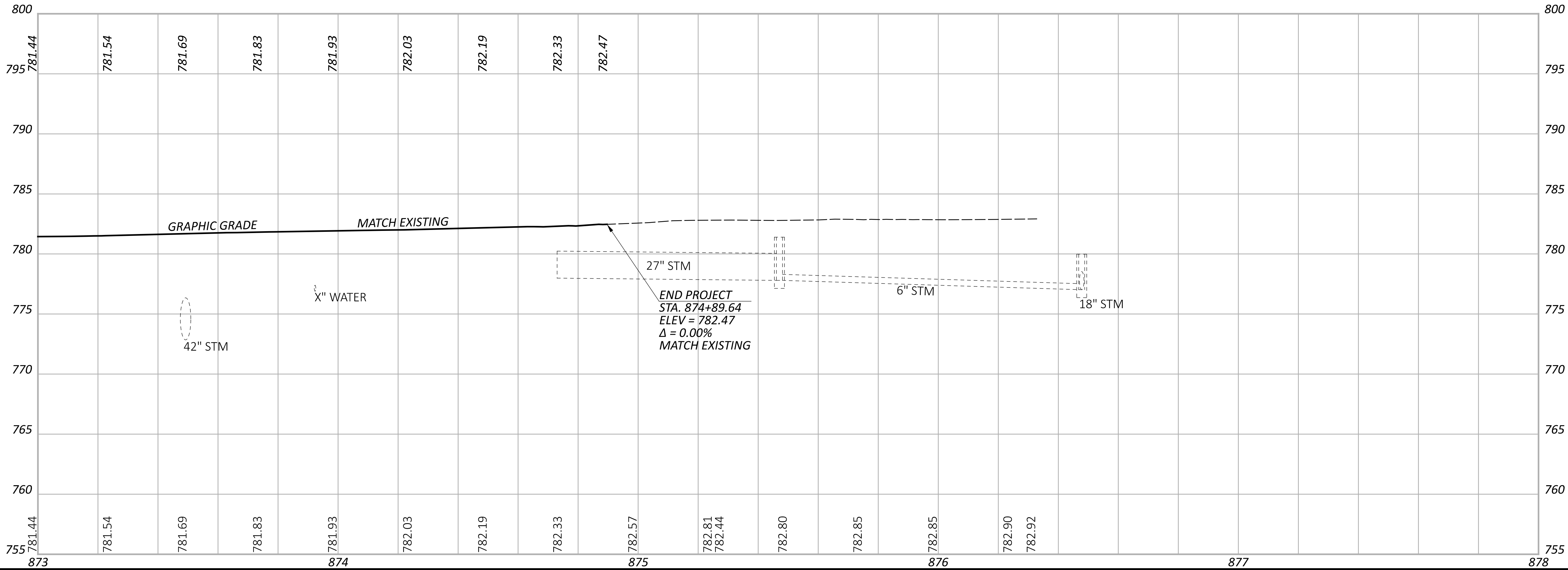

JAC-35-18.16

MODEL: CLP035_X_PVT - 871+00.00 [Sheet] PAPERSIZE: 34x22 (in.) DATE: 11/21/2025 TIME: 10:48:31 AM USER: kmassaros
O:\2024\02638\C. Design\118107_JAC-35-18\6\400-Engineering\Roadway\Sheets\118107_XS001.dgn

[illegible]

SEEDING														END AREA		VOLUME		CROSS SECTIONS - US 35 STA. 871+75.00 TO STA. 872+25.00	
END WIDTH	SQ. YDS.													CUT	FILL	CUT	FILL		
		790												790					
		785												785	10	13			
		780												780			8	13	
		775												775					
		770												770					
		765	60	50	40	30	20	10	0	10	20	30	40	50	60	765			
		790												790	8	14			
		785												785			7	13	
		780												780					
		775												775					
		770												770					
		765	60	50	40	30	20	10	0	10	20	30	40	50	60	765			
		790												790	8	14			
		785												785					
		780												780					
		775												775					
		770												770					
		765	60	50	40	30	20	10	0	10	20	30	40	50	60	765			
		790												790					
		785												785					
		780												780					
		775												775					
		770												770					
		765	60	50	40	30	20	10	0	10	20	30	40	50	60	765			
SHEET TOTAL														SHEET TOTALS			22	40	

DESIGN AGENCY
STRUCTUREPOINT
INC.

DESIGNER
ANW

REVIEWER
KAM 11-18-25

PROJECT ID
118107

SHEET
P.18

TOTAL
24

JAC-35-18.16

MODEL: CLP035_X_PVT - 872+50.00 [Sheet] PAPER SIZE: 34x22 (in.) DATE: 11/21/2025 TIME: 10:48:38 AM USER: kmassaros
O:\2024\02638\C. Design\118107_JAC-35-18\6400-Engineering\Roadway\Sheets\118107_XS001.dgn

[illegible]

JAC-35-18.16

MODEL: CLP035_X_PVT - 873+25.00 [Sheet] PAPER SIZE: 34x22 (in.) DATE: 11/21/2025 TIME: 10:48:40 AM USER: kmassaros
O:\2024\02638\C. Design\118107_JAC-35-18\6400-Engineering\Roadway\Sheets\118107_XS001.dgn

[illegible]

SEEDING														END AREA		VOLUME		CROSS SECTIONS - US 35 STA. 874+00.00 TO STA. 874+75.00	
END	SO.													CUT	FILL	CUT	FILL		
WIDTH	YDS.																		
		790												790					
		785												785	9	0			
		780												780			7	0	
		775												775					
		770	60	50	40	30	20	10					770	782.33					
														874+75.00					
														782.33					
														0					
		790												790					
		785												785	7	0			
		780												780			7	1	
		775												775					
		770	60	50	40	30	20	10					770	782.19					
														874+50.00					
														782.19					
														0					
		790												790					
		785												785	8	2			
		780												780			7	4	
		775												775					
		770	60	50	40	30	20	10					770	782.03					
														874+25.00					
														782.03					
														0					
		790												790					
		785												785	8	6			
		780												780			7	7	
		775												775					
		770	60	50	40	30	20	10					770	781.93					
														874+00.00					
														781.93					
														0					
SHEET TOTAL		790												790					
		785												785					
		780												780					
		775												775					
		770	60	50	40	30	20	10					770	SHEET TOTALS			28	12	

JAC-35-18.16

MODEL: CLP035_X_PVT - 874+89.64 [Sheet] PAPER SIZE: 34x22 (in.) DATE: 11/21/2025 TIME: 10:48:44 AM USER: kmassaros
O:\2024\02638\C. Design\118107_JAC-35-18\6400-Engineering\Roadway\Sheets\118107_XS001.dgn

[illegible]

EARTHWORK QUANTITY SUBSUMMARY			
STATION FROM	STATION TO	203	203
		EXCAVATION	EMBANKMENT
		CY	CY
871+00.00	871+50.00	5	8
871+75.00	872+25.00	22	40
872+50.00	873+00.00	26	36
873+25.00	873+75.00	24	31
874+00.00	874+75.00	28	12
874+89.64		2	0
TOTALS CARRIED TO GENERAL SUMMARY		107	127

790

785

780

775

770

60 50 40 30 20 10

END PROJECT

874+89.64

BACK 785

770

EARTHWORK QUANTITY SUBSUMMARY			
STATION FROM	STATION TO	203	203
		EXCAVATION	EMBANKMENT
		CY	CY
871+00.00	871+50.00	5	8
871+75.00	872+25.00	22	40
872+50.00	873+00.00	26	36
873+25.00	873+75.00	24	31
874+00.00	874+75.00	28	12
874+89.64		2	0
TOTALS CARRIED TO GENERAL SUMMARY		107	127

END AREA		VOLUME	
CUT	FILL	CUT	FILL
0	0	2	0
SHEET TOTALS		2	0

CROSS SECTIONS - US 35
STA. 874+89.64 TO STA. 874+89.64

DESIGN AGENCY STRUCTUREPOINT <small>AMERICAN INC.</small>	
DESIGNER ANW	
REVIEWER KAM 11-18-25	
PROJECT ID 118107	
SHEET P.22	TOTAL 24

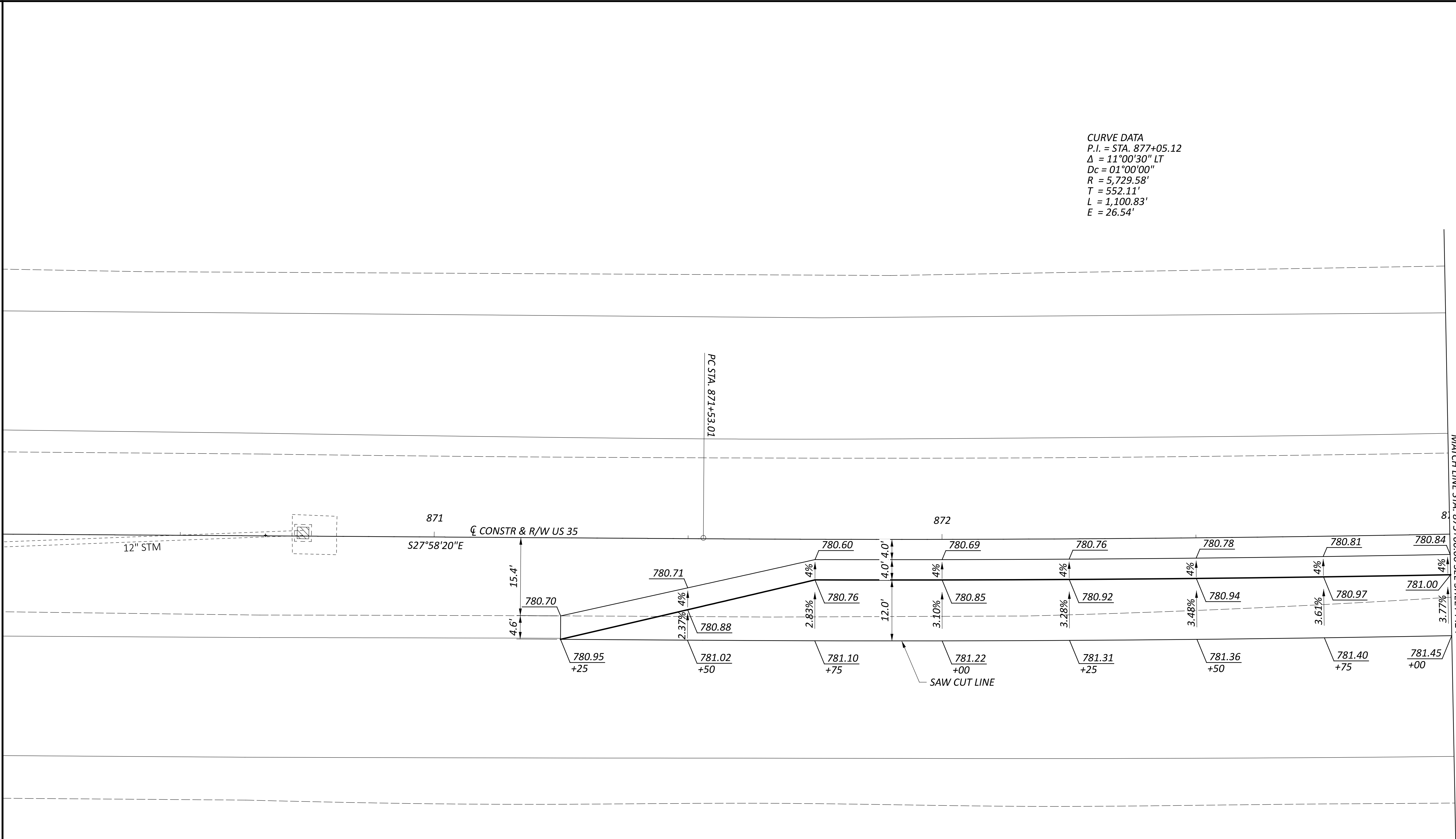

CURVE DATA
P.I. = STA. 877+05.12
Δ = 11°00'30" LT
Dc = 01°00'00"
R = 5,729.58'
T = 552.11'
L = 1,100.83'
E = 26.54'

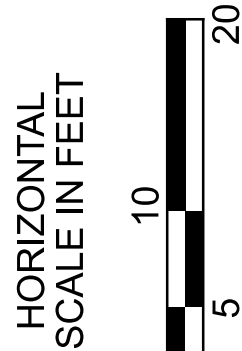

PAVEMENT DETAILS - US 35

DESIGN AGENCY	
STRUCTUREPOINT INC.	
DESIGNER	
ANW	
REVIEWER	
KAM 11-18-25	
PROJECT ID	
118107	
SHEET	TOTAL
P.23	24



HORIZONTAL
SCALE IN FEET



5 10 20

PAVEMENT DETAILS - US 35

DESIGN AGENCY

AMERICAN
STRUCTUREPOINT
INC.

DESIGNER

ANW

REVIEWER

KAM 11-18-25

PROJECT ID

118107

SHEET TOTAL

2